



Your partner for  
disposal technology



# The JLB - Advantages at a glance



## Large feeding opening

(L x W x H) 2250 mm x 1085 mm x 1700 mm



## High throughput capacity

One bale per hour (approx. 400 kg per hour)



## Compact design

and the choice between 3 feeding variants

# Handling of large-volume cardboard boxes with simultaneous compact design

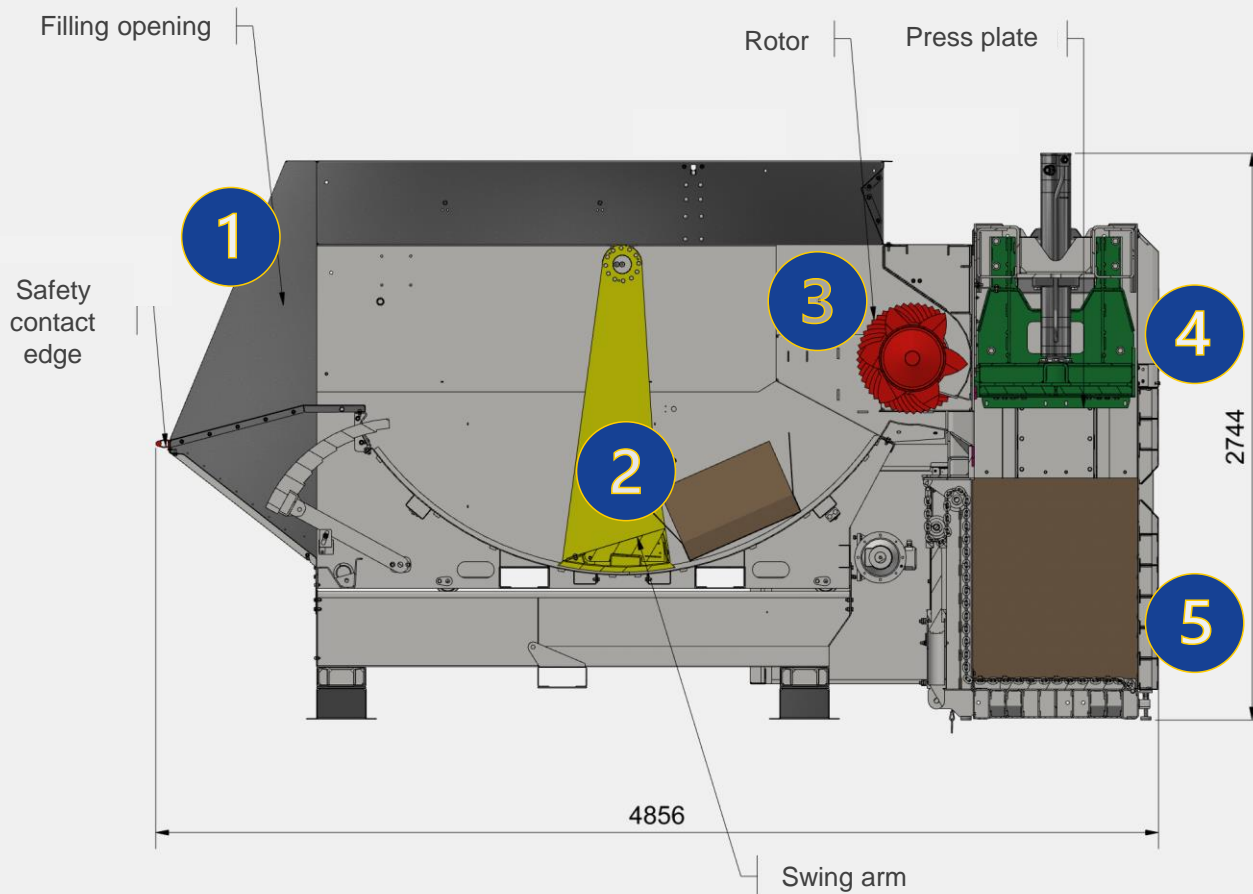

- 1** The material is inserted into the feeding opening, which is 1.08 m wide and 2.25 m deep.
- 2** A swing arm pushes the material (e.g. cardboard, film or emptied PET bottles) to the rotor automatically.
- 3** The rotor conveys the material into the press chamber.
- 4** Once the material has been conveyed into the press chamber, the compaction process begins automatically.
- 5** When the bale is ready, it is tied manually and ejected by the hydraulic bale ejector.

# Bale dimensions of the JLB

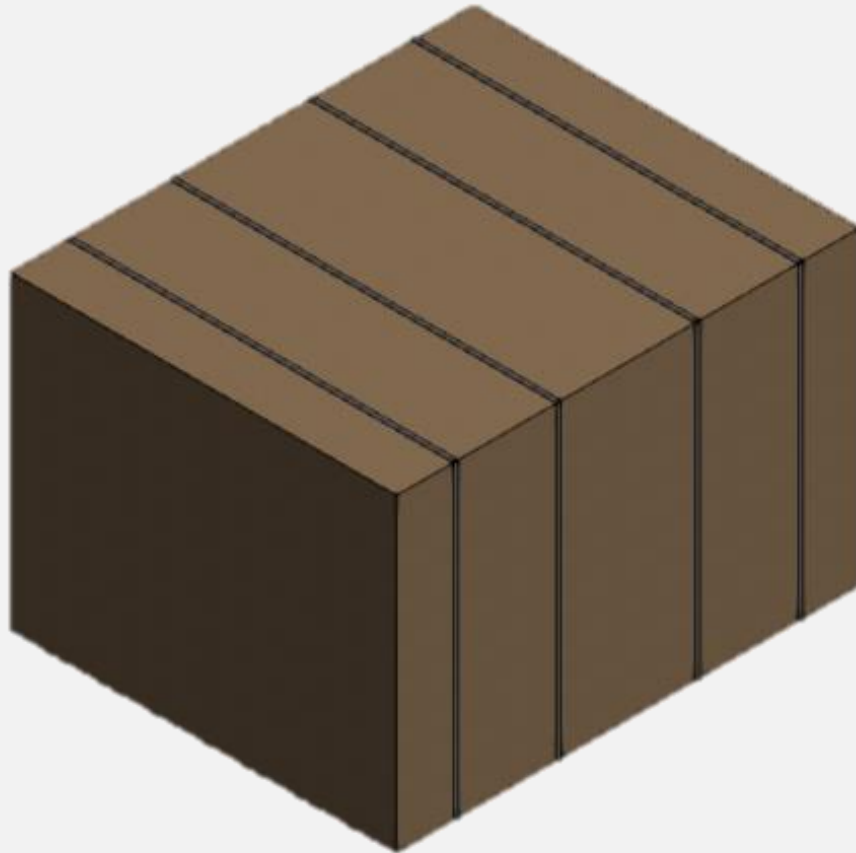

## Directly marketable bales



Approx. 400 kg



(H x W x D)  
800 x 1200 x 1000 mm



Suitable for compacting **cardboard**,  
**film**, **octabins** or **emptied PET**  
**bottles and cans**



# The feeding variants of the JLB

## Swing arm

for conveying material in front of the rotor.

Single rotor for conveying the material into the press chamber.

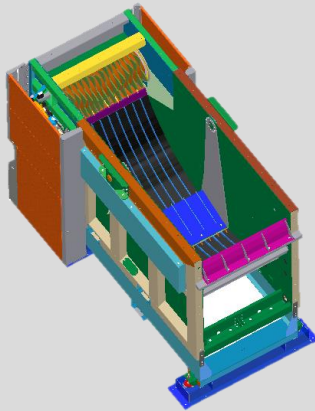

### Swing hopper

Suitable for cardboard and film

## Pendulum

for conveying material in front of the rotor.

Double rotor for conveying the material into the press chamber.

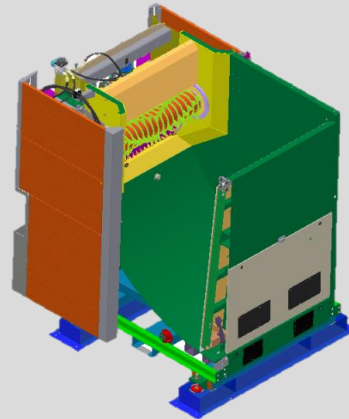

### Pendulum hopper

Suitable for emptied PET bottles and cans

## Pusher

for conveying material in front of the rotor.

Double rotor for conveying the material into the press chamber.

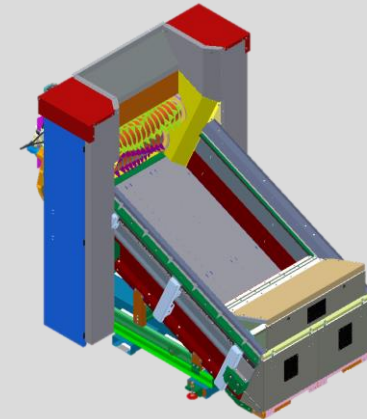

### Hydraulic pusher

Suitable for octabins

# The dimensions of the JLB

for each feeding variant

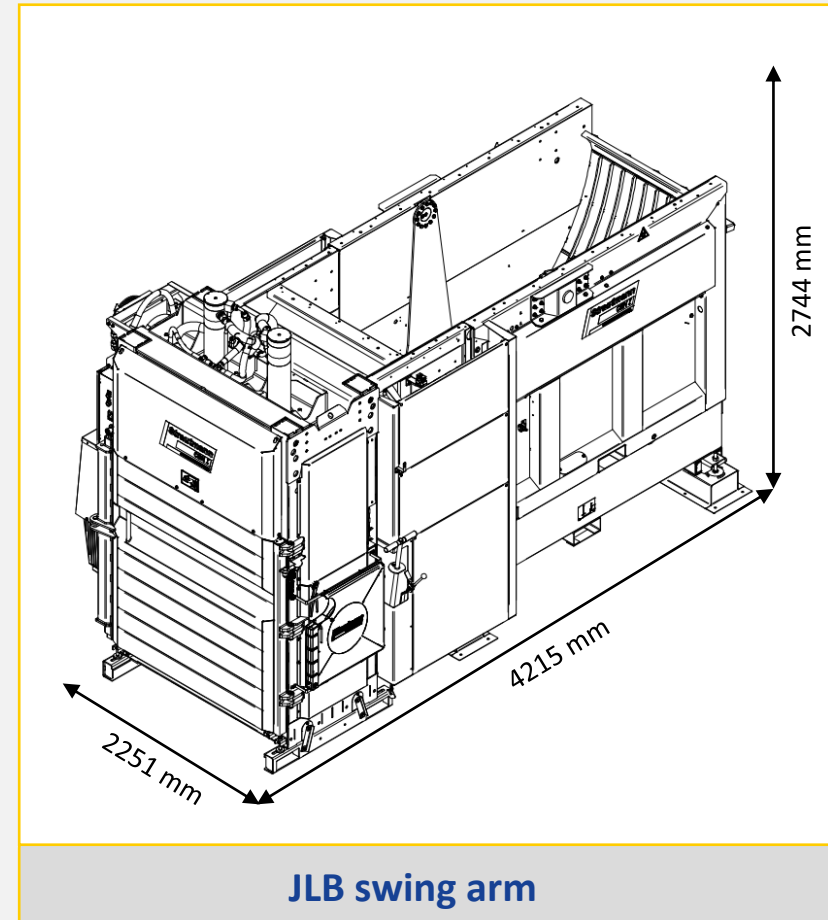
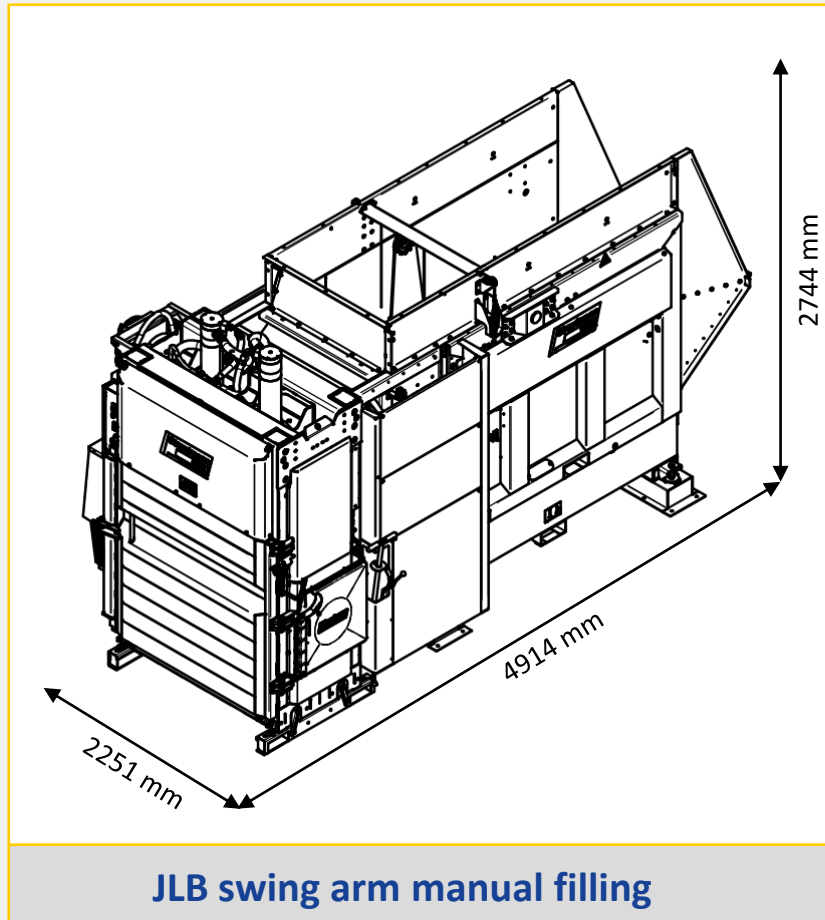

# The dimensions of the JLB

for each feeding variant

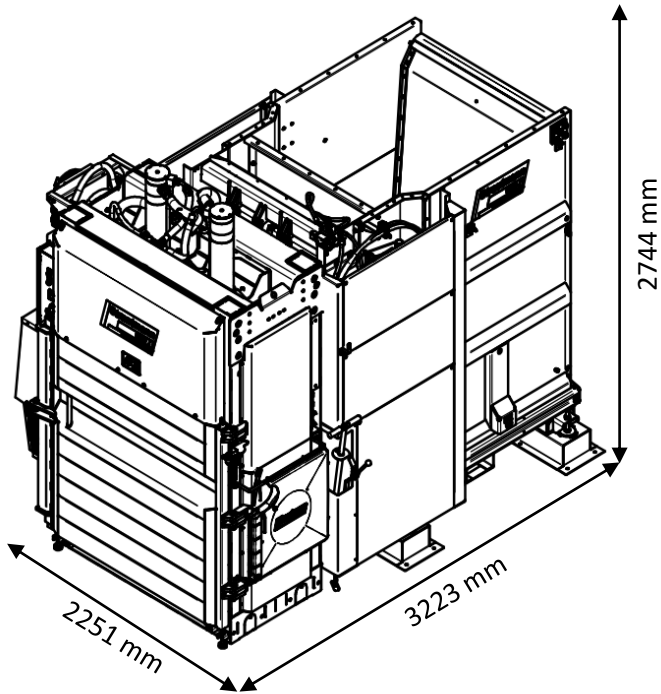

**JLB pendulum hopper**

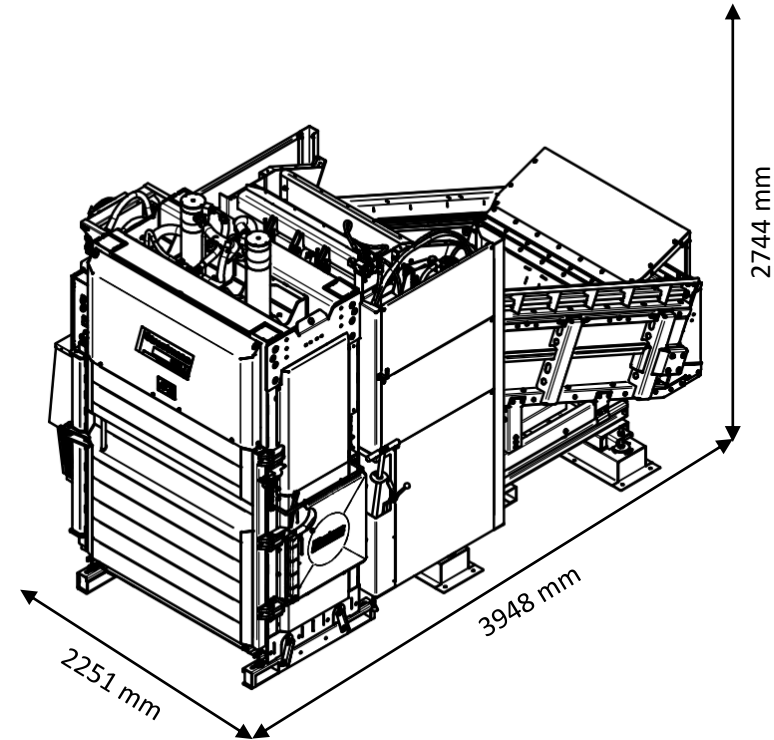

**JLB hydraulic pusher**

# JLB – Filling variants

Manual filling at ground level





# JLB – Filling variants

Manual filling at dock level



# JLB – Filling variants

Filling by lifting and tipping device





# JLB – Filling variants

Filling by conveyor belt



# Your partner for disposal technology



Compact & Bale Ltd, Unit 7 The Hop Kilns, Goblands  
Farm Business Centre, Hadlow, Kent, TN11 0LT



[www.compact-and-bale.com](http://www.compact-and-bale.com)



01732 852244



[sales@compactandbale.com](mailto:sales@compactandbale.com)

